

## Visibility Triangle Standards

See Article 14-5D of City Code for full Intersection Visibility Standards.

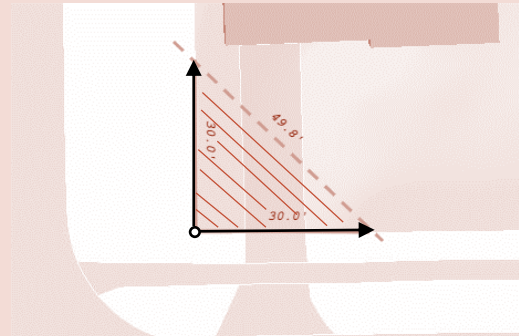

Two Arterial Streets - Vision triangle is measured at intersection of right-of-way lines, 30 feet along each line.

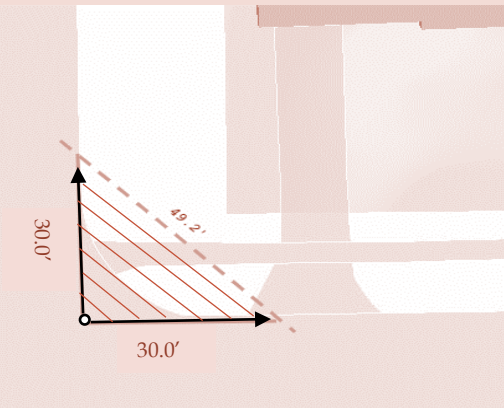

Collector Streets and Local Streets- Vision triangle is measured at the point of intersection from the curb lines extended, 30 feet along each curb.

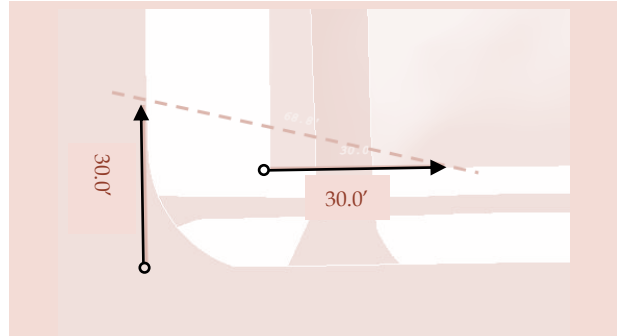

Collector or Local Street and Arterial Street- Vision triangle is measured along right-of-way line of arterial street, 30 feet from intersection of right-of-way lines. Along collector or local street, measure 30 feet from where curb lines intersect.

### Visibility Triangle Standards

Fences higher than two feet above the curb level are prohibited within the vision triangles, however, fences that are of a type that is less than twenty percent (20%) solid, such as split rail, open weave, or wrought iron, are permitted within the vision triangle; provided, that such fences are kept free from plantings and other materials that are more than two feet (2') in height.

### For More Information

- For permit information and permit application visit [www.icgov.org/permitinfo](http://www.icgov.org/permitinfo)
- For City Code visit [www.icgov.org/city-government](http://www.icgov.org/city-government) under City Code section. *Code section for fencing may be found under "Accessory Uses" 14-4C-2L*
- For general questions call us at 319-356-5120



CITY OF IOWA CITY  
UNESCO CITY OF LITERATURE

# Fence Information and Guidelines

*Neighborhood &  
Development Services*





## Is A Permit Required to Build a Fence?

### A Permit is required for:

- Fences over 6 feet in height
- Electrical fences
- Barbed wire fences
- Any retaining wall over 4 feet in height as measured from the top of the footing to the top of the wall
- A retaining wall of any height that supports a surcharge or impounds flammable liquids

## Things to Consider Before Starting Your Fence Project.

- Are there private covenants in your subdivision agreements?  
*Contact the Johnson County Recorder's office at 319-356-6093 for private covenants & subdivision agreements.*
- Where are your property lines?  
*The City of Iowa City **does not** survey property lines.*
- Call 811 before you dig.  
*Iowa one call (800)292-8989 or visit [www.iowaonecall.com](http://www.iowaonecall.com)*
- What type of lot do you have?  
*Double frontage, interior, or corner lot etc.*
- Are there easement restrictions?  
*Contact Development Services at 319-356-5120 for easement restrictions.*

## Setback Requirements

- Fences, walls and hedges must be set back at least 2 feet from any alley or street right-of-way line.
- To avoid blocking the view and for safety reasons, on corner lots, fences, walls, and hedges over 2 feet in height must comply with the provisions of Article 14-5D, Intersection Visibility Standards.

- In properties zoned residential and properties with frontages within 50 feet of a residential zones, fence height is limited to 4 feet in the front yard area. However, on double frontage lots and reverse corner lots, along expressways or an arterial street the height limit is increased to 6 feet. *Be aware that corner lots have two front yards.*

Lot, Corner – a lot located at the intersection of 2 or more streets.

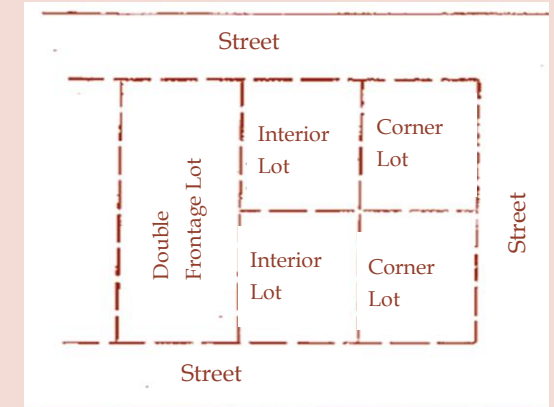

Lot, Reversed Corner: a corner lot, the rear of which abuts the side of another lot.

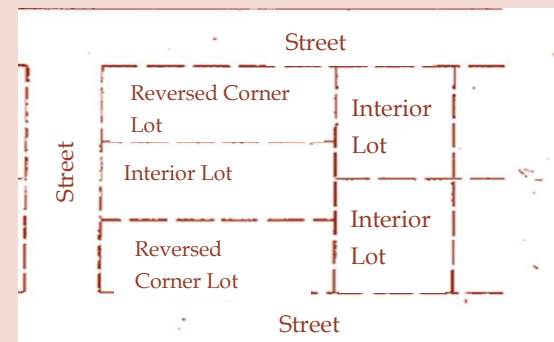

Lot, Frontage: The continuous width of a lot measured along the public right-of-way line.